

COAL CREEK VILLAGE

Lafayette, CO

2013 COMPOSITE OF "NORTH" & "SOUTH"

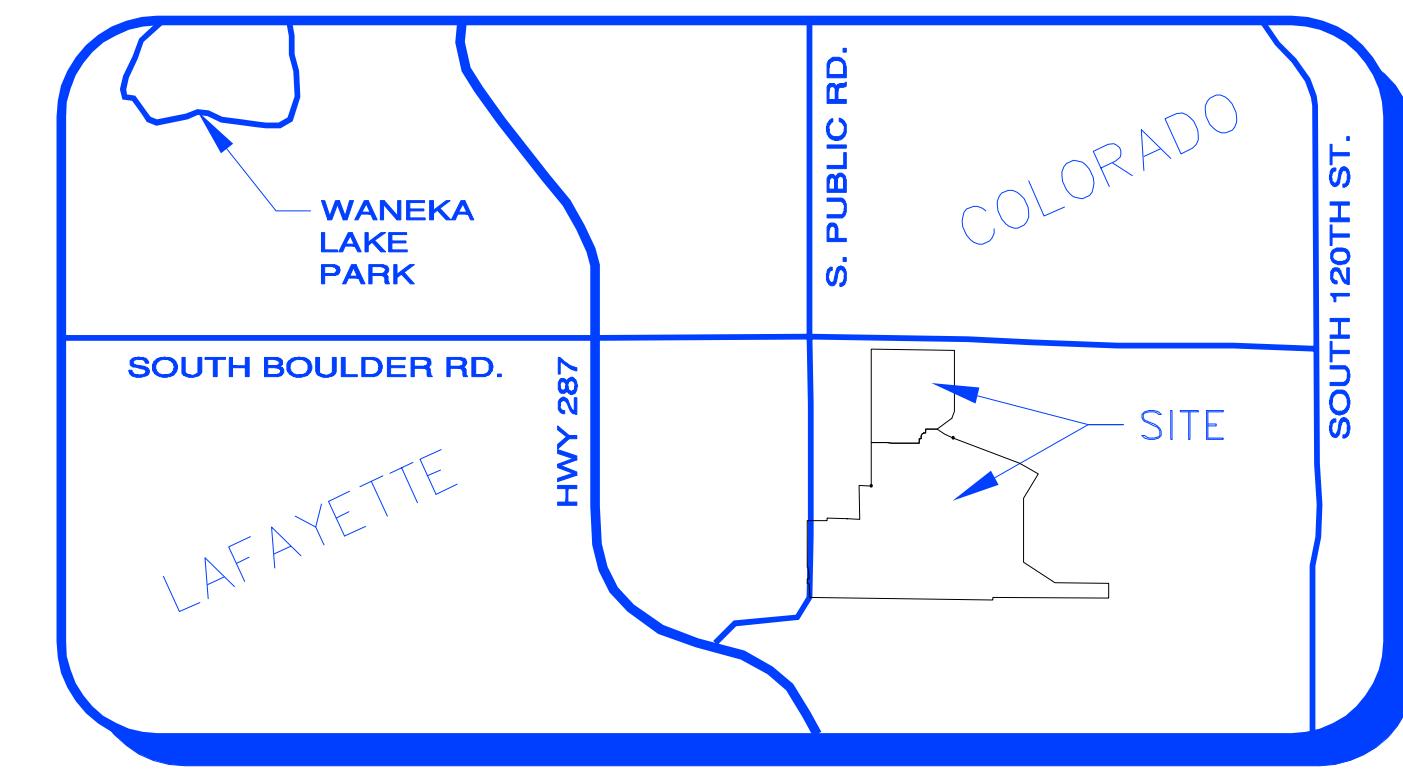

VICINITY MAP 1" = 2000'

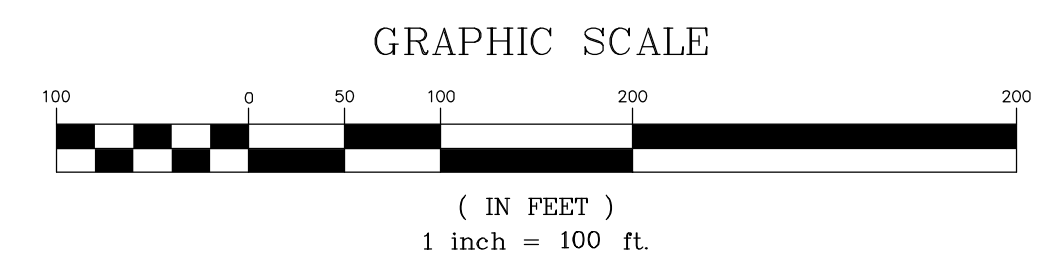

COAL CREEK VILLAGE RESIDENTIAL UNITS SUMMARY			
	AMENDED COAL CREEK "SOUTH"	NEW COAL CREEK "NORTH"	PUD TOTAL
Single Family	129	25	154
Duplex	66	36	102
Multifamily	125	0	125
	320	61	381

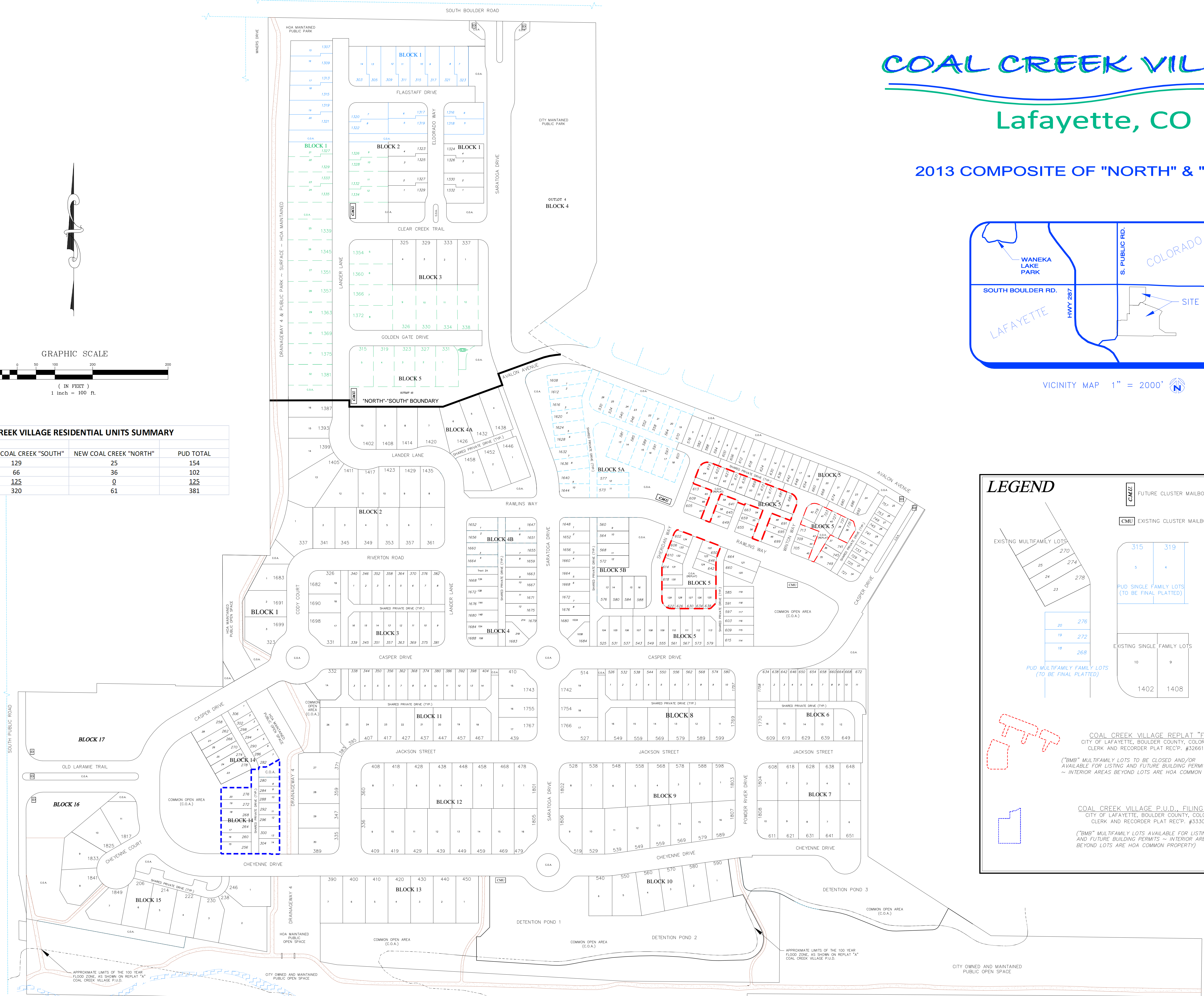

LEGEND

- FUTURE CLUSTER MAILBOX UNITS
- EXISTING CLUSTER MAILBOX UNITS
- EXISTING MULTIFAMILY LOTS
- PUD SINGLE FAMILY LOTS (TO BE FINAL PLATTED)
- PUD MULTIFAMILY FAMILY LOTS (TO BE FINAL PLATTED)
- EXISTING SINGLE FAMILY LOTS
- COAL CREEK VILLAGE REPLAT "F"
CITY OF LAFAYETTE, BOULDER COUNTY, COLORADO
CLERK AND RECORDER PLAT REC'P. #3266171
(*BMS* MULTIFAMILY LOTS TO BE CLOSED AND/OR AVAILABLE FOR LISTING AND FUTURE BUILDING PERMITS ~ INTERIOR AREAS BEYOND LOTS ARE HOA COMMON PROPERTY)
- COAL CREEK VILLAGE P.U.D., FILING NO. 8
CITY OF LAFAYETTE, BOULDER COUNTY, COLORADO
CLERK AND RECORDER PLAT REC'P. #3330513
(*BMS* MULTIFAMILY LOTS AVAILABLE FOR LISTING AND FUTURE BUILDING PERMITS ~ INTERIOR AREAS BEYOND LOTS ARE HOA COMMON PROPERTY)